

## REMOVAL

### 1. REMOVE STEERING WHEEL PAD

#### NOTICE:

- If the airbag connector is disconnected with the ignition switch at ON or ACC, DTCs will be recorded.
- Never use airbag parts from another vehicle. When replacing parts, replace with new ones.

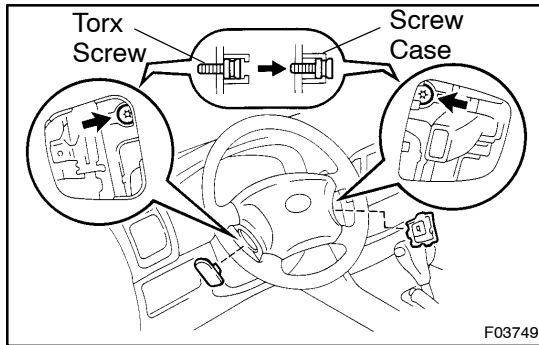

- Place the front wheels facing straight ahead.
- Remove the steering wheel lower No.2 and No.3 covers.
- Using a torx socket wrench, loosen the 2 torx screws.

#### HINT:

Loosen the 2 screws until the groove along the screw circumference catches on the screw case.

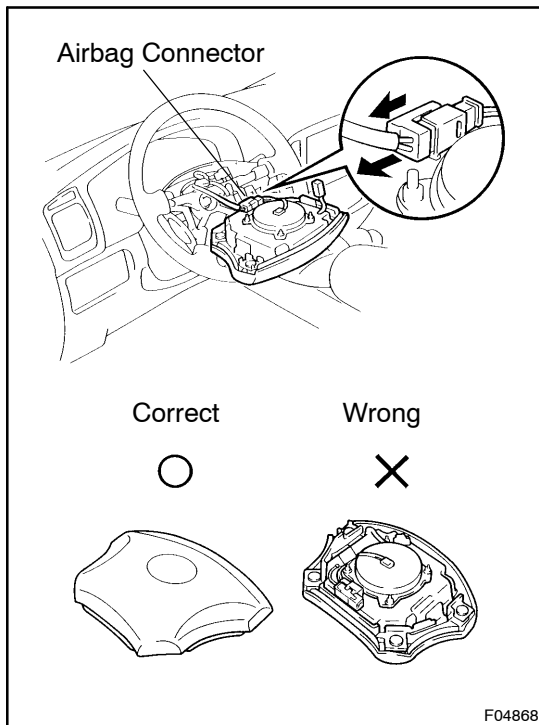

- Pull the pad out from the steering wheel and disconnect the airbag connector.
- Disconnect the connector.

#### CAUTION:

- When storing the wheel pad, keep the upper surface of the pad facing upward.
- Never disassemble the wheel pad.

#### NOTICE:

When removing the wheel pad, take care not to pull the airbag wire harness.

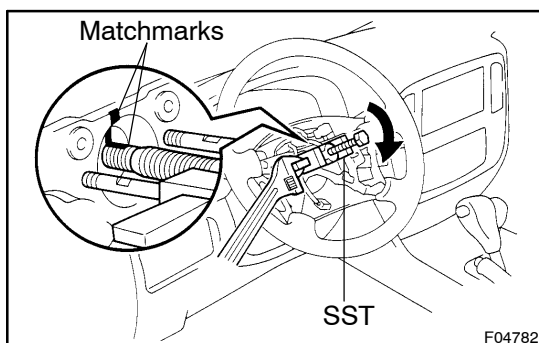

### 2. REMOVE STEERING WHEEL

- Disconnect the connector.
- Remove the steering wheel set nut.
- Place matchmarks on the steering wheel and main shaft assembly.
- Using SST, remove the wheel.  
SST 09950-50012 (09951-05010, 09952-05010, 09953-05020, 09954-05020)

**3. REMOVE UPPER AND LOWER COLUMN COVERS**

Remove the 3 screws.

**4. REMOVE COMBINATION SWITCH WITH SPIRAL CABLE**

- (a) Disconnect the 5 connectors.
- (b) Disconnect the airbag connector.
- (c) Remove the 3 screws.

**5. REMOVE SPIRAL CABLE**

(See page [BE-29](#))

**NOTICE:**

**Do not disassembly the cable or apply oil to it.**

**6. REMOVE SCUFF PLATE****7. REMOVE COWL TRIM**

Remove the clip.

**8. REMOVE CLUSTER FINISH PANEL**

Remove the connector.

**9. REMOVE LOWER NO.1 PANEL**

- (a) Remove the 2 screws and disconnect the hood lock release lever from the panel.
- (b) Remove the 2 screws and disconnect the fuel lid release lever from the panel.
- (c) Remove pad set screw.

**10. REMOVE LH LOWER PANEL**

Remove the 4 bolts.

**11. REMOVE NO.2 HEATER TO REGISTER DUCT**

Remove the screw.

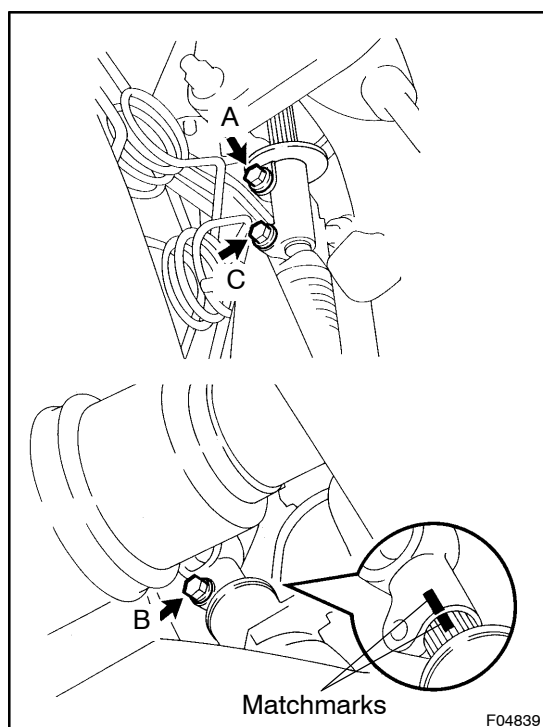
**12. DISCONNECT NO.2 INTERMEDIATE SHAFT ASSEMBLY**

- (a) Place matchmarks on the intermediate shaft and control valve shaft.
- (b) Loosen the bolt A.
- (c) Remove the bolt B and the bolt C.

**13. REMOVE NO.2 INTERMEDIATE SHAFT ASSEMBLY****14. REMOVE HOLE COVER**

Remove the 4 bolts.

**15. REMOVE STEERING COLUMN ASSEMBLY**

- (a) Disconnect the connectors.

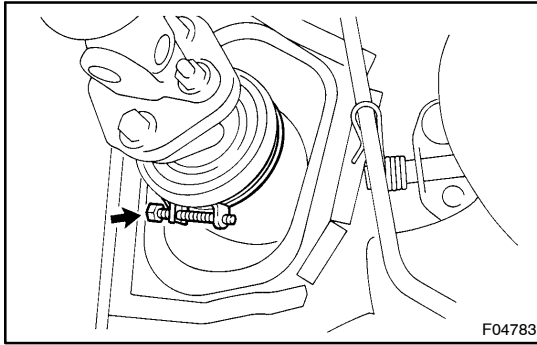

- (b) Loosen the hose clamp.
- (c) Remove the 4 column assembly set nuts.

**16. REMOVE SLIDING YOKE**

- (a) Remove the bolt A.
- (b) Remove the thrust stopper.

**17. REMOVE HOSE CLAMP**

**18. REMOVE NO.2 HOLE COVER**